

The Courses & distances DOWN
the RIVER from the Maple to the WOX
are.

- N 80 E 112
- S 77 E 118
- S 80 E 30
- East - 46
- N 55 E 26
- N 2 W 106.7
- N 22 W 50.
- N 36 W 71.
- N 4 E 65 TO WOX
- 624.7

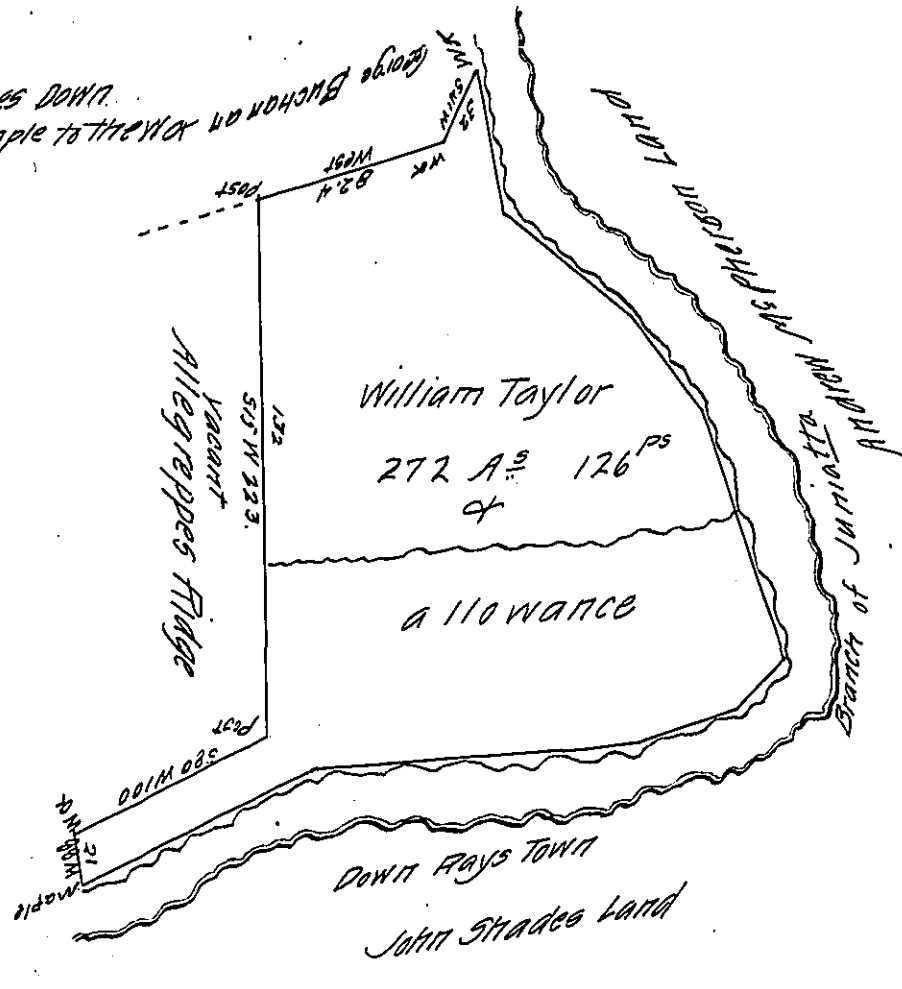

Situate on the Northside of the Rays town branch of Juniatta in Hope well
Township Huntingdon County Containing two hundred & seventy two acres and 126
perches and allowance including an improvement Surveyed the 24th day of Oct: 1820
Examined by me the 21st day of Nov: 1831 in pursuance of a Warrant granted to William Taylor dated the 14th day of Oct: 1820

To Samuel Cochran Esq.
Surveyor General

P^s Wm. Freed D.S.

IN TESTIMONY that the above is a copy of the original remaining on file in
the Department of Internal Affairs of Pennsylvania, made
conformably to an Act of Assembly approved the 16th day of
February, 1833, I have hereunto set my Hand and caused
the Seal of said Department to be affixed at Harrisburg,
this second day of April 1907

David B. Brown
Secretary of Internal Affairs.